



Global Leadership Centre University of Oxford

A physical and digital hub for leaders





Contents

Rationale for the Global Leadership Centre

Purpose and strategy

Working with organisations and leaders is fundamental to pursuing our own purpose and academic mission. If we are to support the transformation of business to become the engine of a more sustainable, prosperous, and equal world, we need to provide the highest quality education to current as well as future leaders; and facilitate the challenging conversations and practical innovation that will catalyse systemic change. The Global Leadership Centre will provide the physical and digital space to make that happen.

Education

The Global Leadership Centre has been designed to support this high-level business and leadership education, with a range of formal and informal teaching spaces and state-of-the-art digital tools. This will allow for flexible programmes that can incorporate both face-to-face and remote learning, that can bring diverse teams together from across international organisations, and that can welcome global experts to contribute from wherever they are in the world. Drawing on our experience of the COVID-19 pandemic, it will as far as possible be future-proofed to allow for further technological and other developments.

Location

The Global Leadership Centre will be within a few minutes' walk of the main Saïd Business School building on Park End Street, creating a mini 'campus' that will ease the cross-fertilisation of ideas and close links between business and management research and practice. The Global Leadership Centre will also be on the doorstep of the main University community and will thus encourage closer links with other departments and disciplines.

In addition, the development of the Global Leadership Centre will be part of the regeneration of the west end of the city of Oxford, creating jobs and opportunities for the local community.

Sustainability

Consistent with the values of the School, the development of the Osney Power Station building will endeavour to be as environmentally sustainable as possible. Its location next to the railway station, and reduced parking facilities, will encourage the use of public transport for visitors.

Financial

Saïd Business School is a department of the University of Oxford, which has charitable status. Any surplus made by the School is reinvested in pursuit of its charitable activities – research, education, and the spread of knowledge. The Global Leadership Centre is expected conservatively to improve the School's surplus by approximately £2 million a year, which will go towards the furtherance of its academic mission.



From Osney Power Station to Global Leadership Centre

The old Osney Power Station, opened in 1892, was Oxford's first electrical power plant. An important part of Oxford's industrial heritage, it is fitting that in the future, it will power new models of leadership for the future.

Within a few minutes' walk of the main Saïd Business School building on Park End Street. The Global Leadership Centre will complete a mini business 'campus' on the doorstep of the main University area.

The work to transform the Victorian building will capitalise upon leading-edge thinking on sustainable development. We plan for a solar panel installation on the roof, green roofs, and bird and bat boxes. The scheme also adopts many of the Passivehaus principles for energy efficiency, as well as those from the WELL standard to optimise health and well-being. We aim to use electric vehicles to service the building.



Opportunities to support

Your gift will strengthen the foundation of the Global Leadership Centre and Saïd Business School. It will intensify Oxford's efforts to connect, develop, and engage leaders to reshape the economy for the benefit of people and planet.

It will allow you to leave your mark on Oxford, forever, by naming a space or room in the Centre, and by enjoying University-level recognition reserved for major benefactors.



£25 million

The Global Leadership Centre A landmark in the city of Oxford and a beacon of sustainable building practice, the 7500m² complex will include high quality teaching and event spaces, break-out facilities, a riverside terrace and other landscaped external areas, and dining rooms and a club lounge.



£5 million

Courtyard This airy, light-filled space next to the old turbine hall will be a central location for rest, reflection, and networking, providing high visibility among programme participants and visitors.

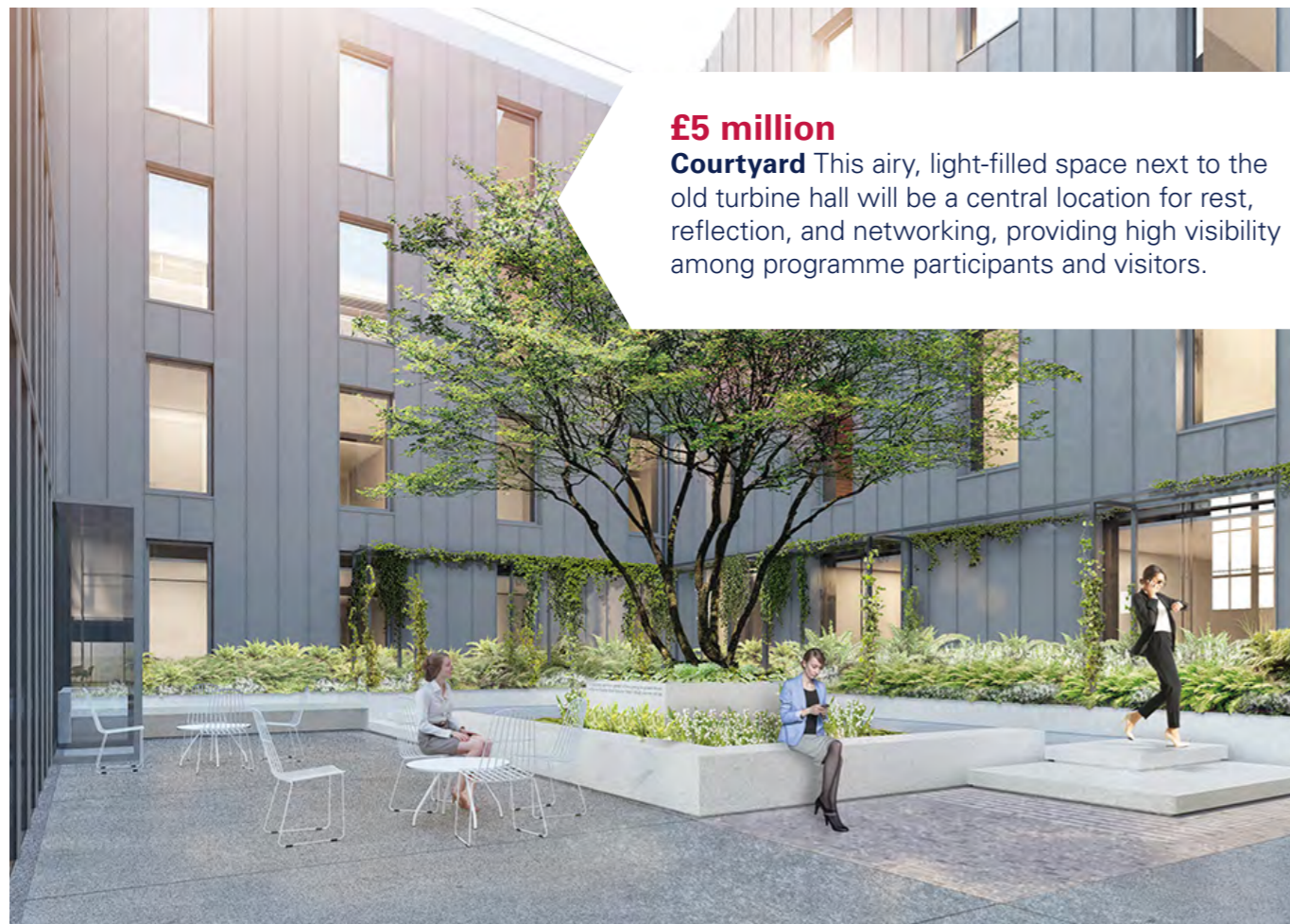

£10 million

Residence Residential leadership programmes are truly immersive experiences, meaning better collaboration, deeper learning, and stronger relationships for every participant. The Global Leadership Centre Residence, right next to the main building, will provide a high-quality 'home from home' for up to 120 executives at any time.

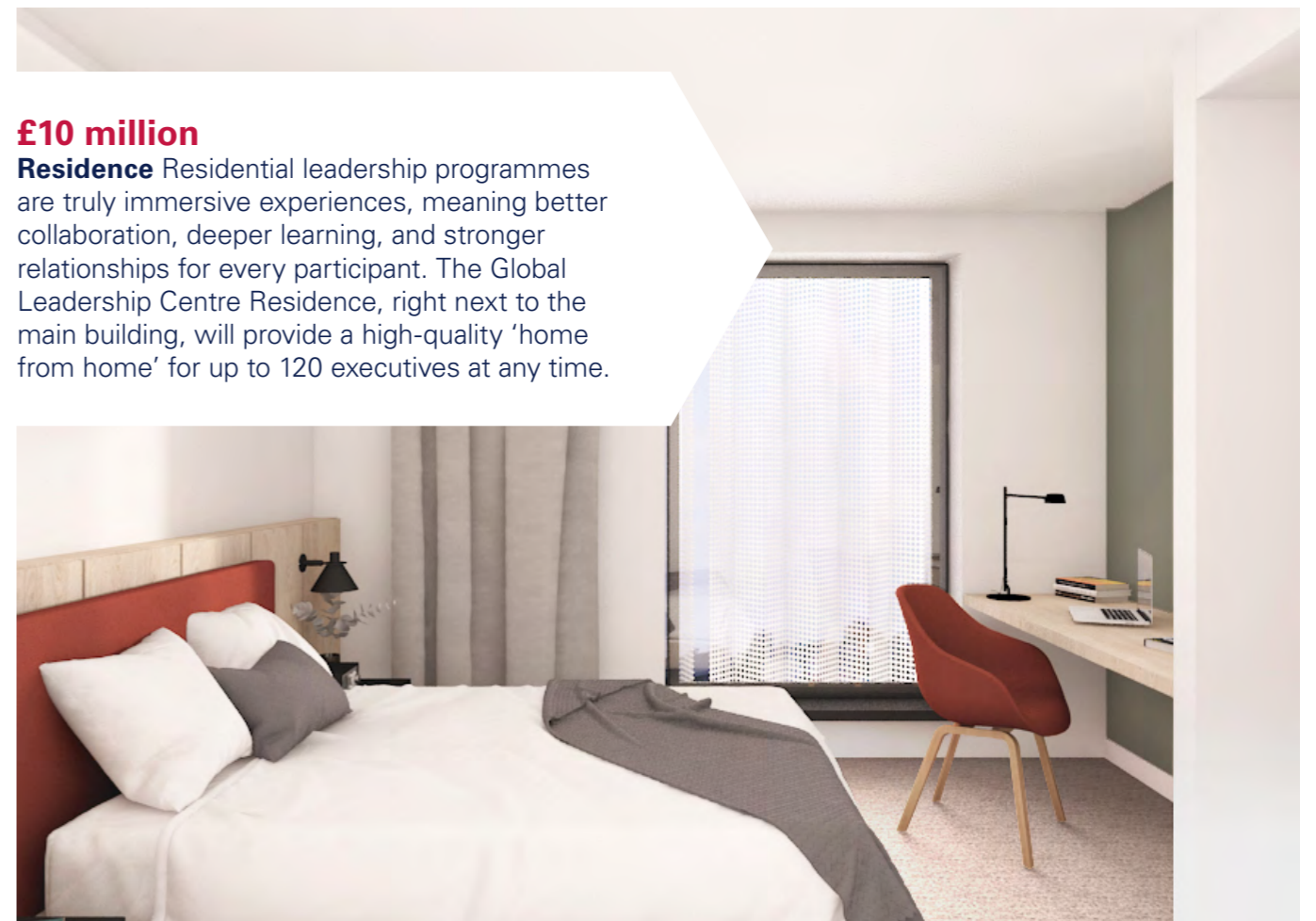



£3 million

Dining Room Dining is central to the Oxford learning experience: it is an opportunity for conversation, for meeting people from different organisations and on different programmes, and for strengthening relationships. The dining areas in the Global Leadership Centre will be remembered warmly by all executives who enjoy eating, drinking, and debating within them.



£3 million

Riverside Terrace The riverside terrace is one of many informal and interesting spaces in the Global Leadership Centre designed to facilitate relaxation, reflection, and networking. It can also be the backdrop to events, and a space for networking and further conversation following presentations and events in the Agora.



£2.5 million

Club Lounge Next to the terrace and enjoying tranquil river views, the Club Lounge is a comfortable area for working, relaxing, and socialising. Like its counterpart in the West Wing of Oxford Saïd's Park End Street building we anticipate that it will quickly become the natural hub for small groups, information conversations and networking.

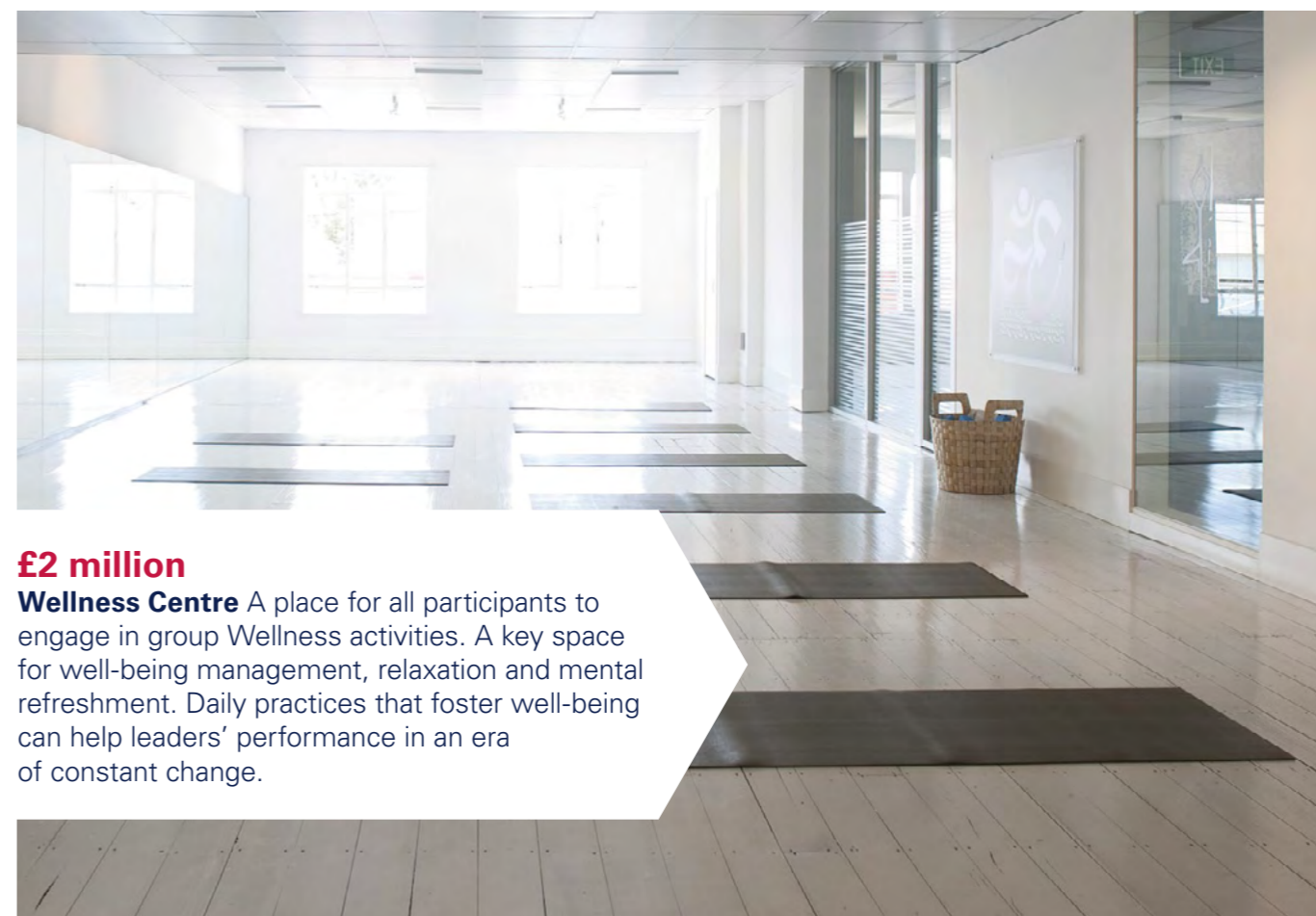

£2 million

Wellness Centre A place for all participants to engage in group Wellness activities. A key space for well-being management, relaxation and mental refreshment. Daily practices that foster well-being can help leaders' performance in an era of constant change.



£1 million

Classrooms The flexible classrooms can be adapted to seat up to 100 delegates theatre-style, or to accommodate small-group working or kinaesthetic learning experiences. They are spacious and modern, and fitted with the latest audio-visual technology as standard.

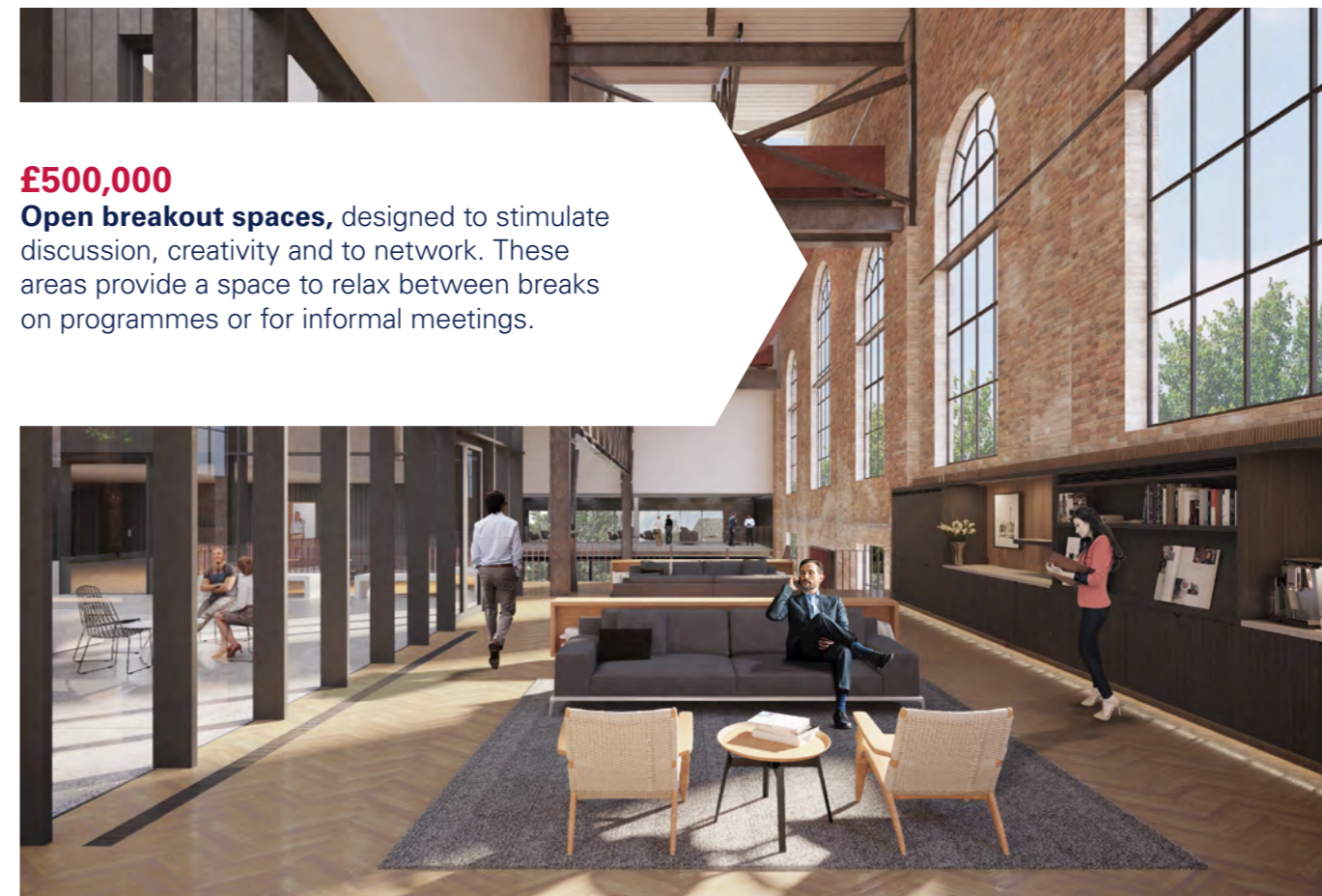

£500,000

Open breakout spaces, designed to stimulate discussion, creativity and to network. These areas provide a space to relax between breaks on programmes or for informal meetings.

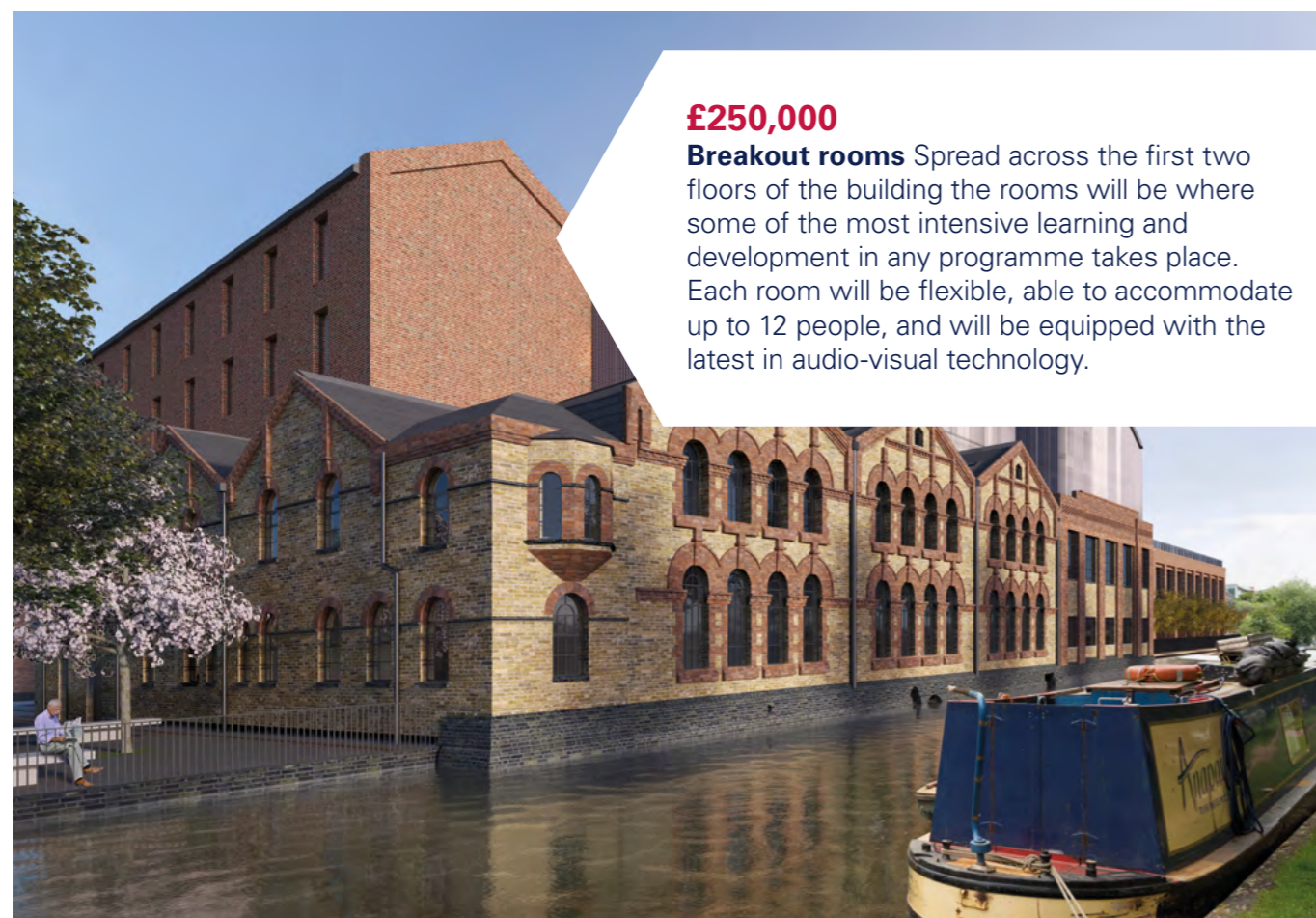

£250,000

Breakout rooms Spread across the first two floors of the building the rooms will be where some of the most intensive learning and development in any programme takes place. Each room will be flexible, able to accommodate up to 12 people, and will be equipped with the latest in audio-visual technology.



Recognition of your generosity

Dean's Circle

The Dean's Circle recognises major benefactors to Saïd Business School. Members will receive regular updates from the Dean, will have the opportunity to attend the annual Rewley Lecture & Dinner, and will be recognised on the School's Wall of Benefactors.

The Vice-Chancellor's Circle

The Vice-Chancellor's Circle recognises benefactors who have provided generous support of between £250,000 and £1 million to the collegiate University by an organisation (a 5-year fixed term) or an individual benefactor. The Vice-Chancellor hosts an annual meeting and gala dinner for members. The donor will also be recognised in the University's main donor report and Encaenia ceremony brochure.

The Vice-Chancellor's Guild

The Vice-Chancellor's Guild recognises benefactors who have provided generous support of between £1 million and £5 million to the collegiate University. This is a new recognition society to be rolled out in 2023.

The Chancellor's Court of Benefactors

Philanthropic contributions that total more than £5 million cumulatively, once received in full, may enable the Chancellor, The Right Hon Lord Patten of Barnes, CH, to invite the organisation benefactor (a 5-year fixed term) or the individual benefactor to join the Chancellor's Court of Benefactors. The Court meets annually in Oxford and provides an opportunity for benefactors to engage with the Chancellor, Vice-Chancellor, Heads of House and senior academics.

Members of the Court who have given exceptional support to the University may also have their names engraved in the Clarendon Arch, near the entrance of the historic Bodleian Library – and may be further honoured with the award of the Chancellor's Court of Benefactors Fellowship.

For more information, please contact:

Tom Childs
Associate Director of Fundraising
Saïd Business School
University of Oxford
T: +44 (0) 7711 561119
E: tom.childs@sbs.ox.ac.uk

